

APPROVED BY		
NAME	INITIALS	DATE
JOE M.		
JOHN R.		
SCOTT P.		
KEITH D.		
ROB J.		
DAVE J.		
TIM W.		

REVISIONS				
ZONE	REV	DESCRIPTION	DATE	APPROVED
NA	C	32" VERSION OF REV. B ARM, WITH MOUNT PIVOT RE-ENFORCED WITH SCHEDULE 40 PIPE AS INDICATED.	01/24/06	

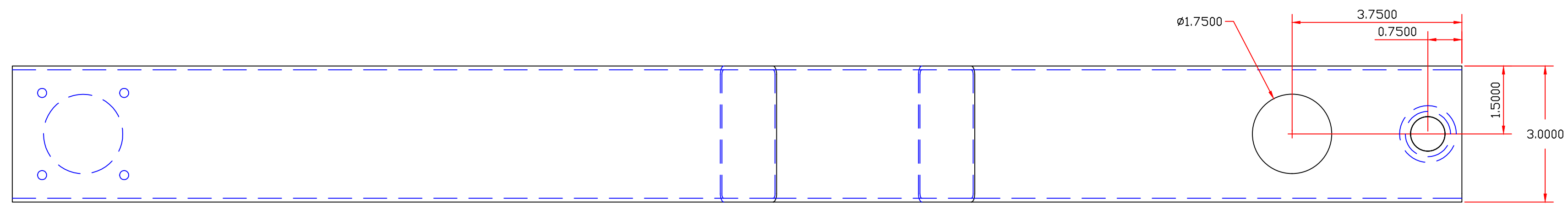

SCHEDULE 40 PIPE TACK WELD IN PLACE TO PREVENT ARM FROM COLLAPSING WHEN MOUNTED

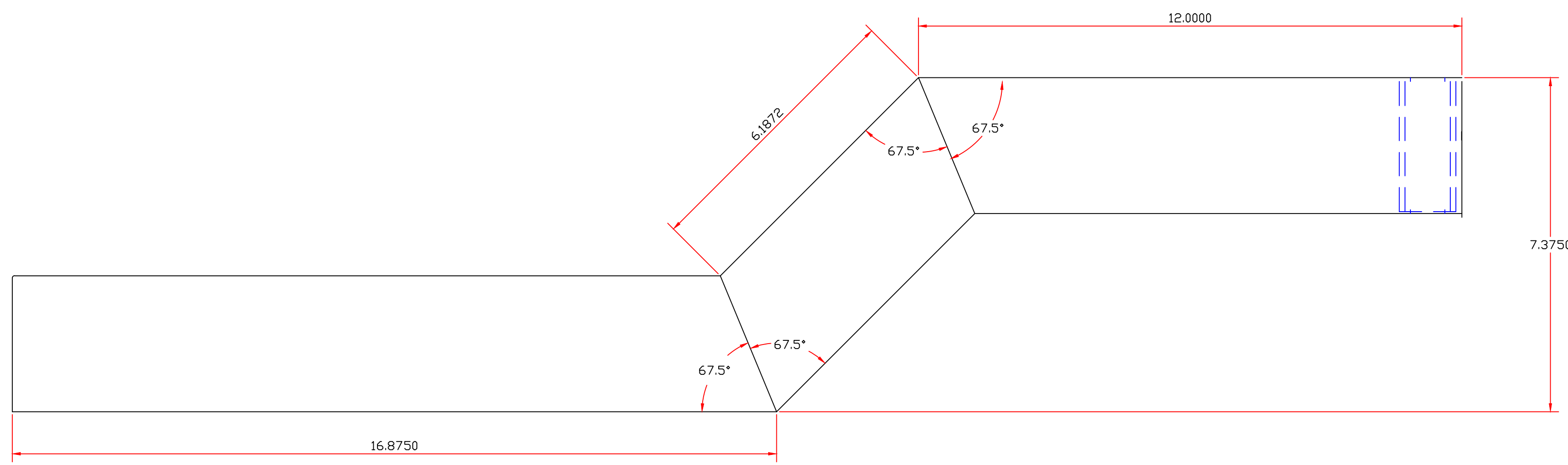
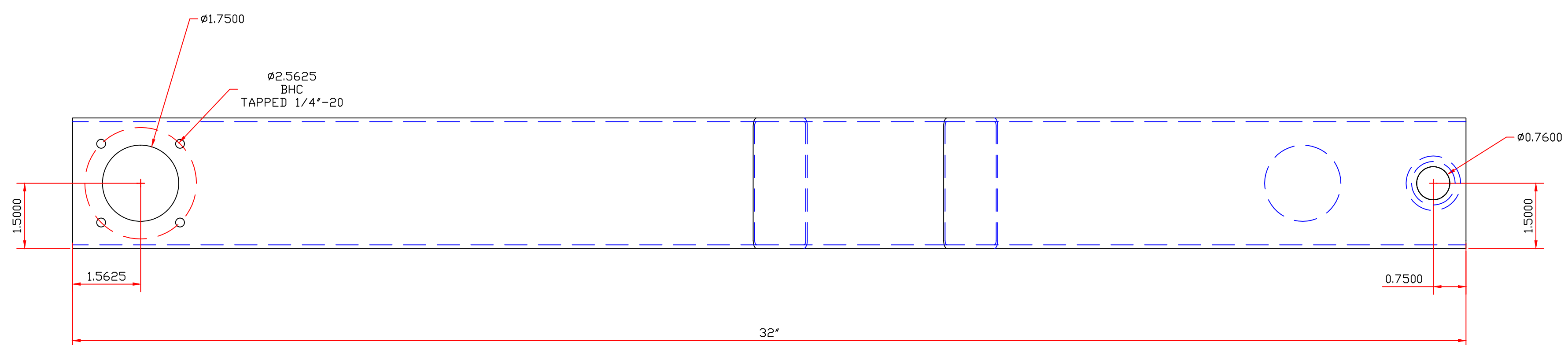
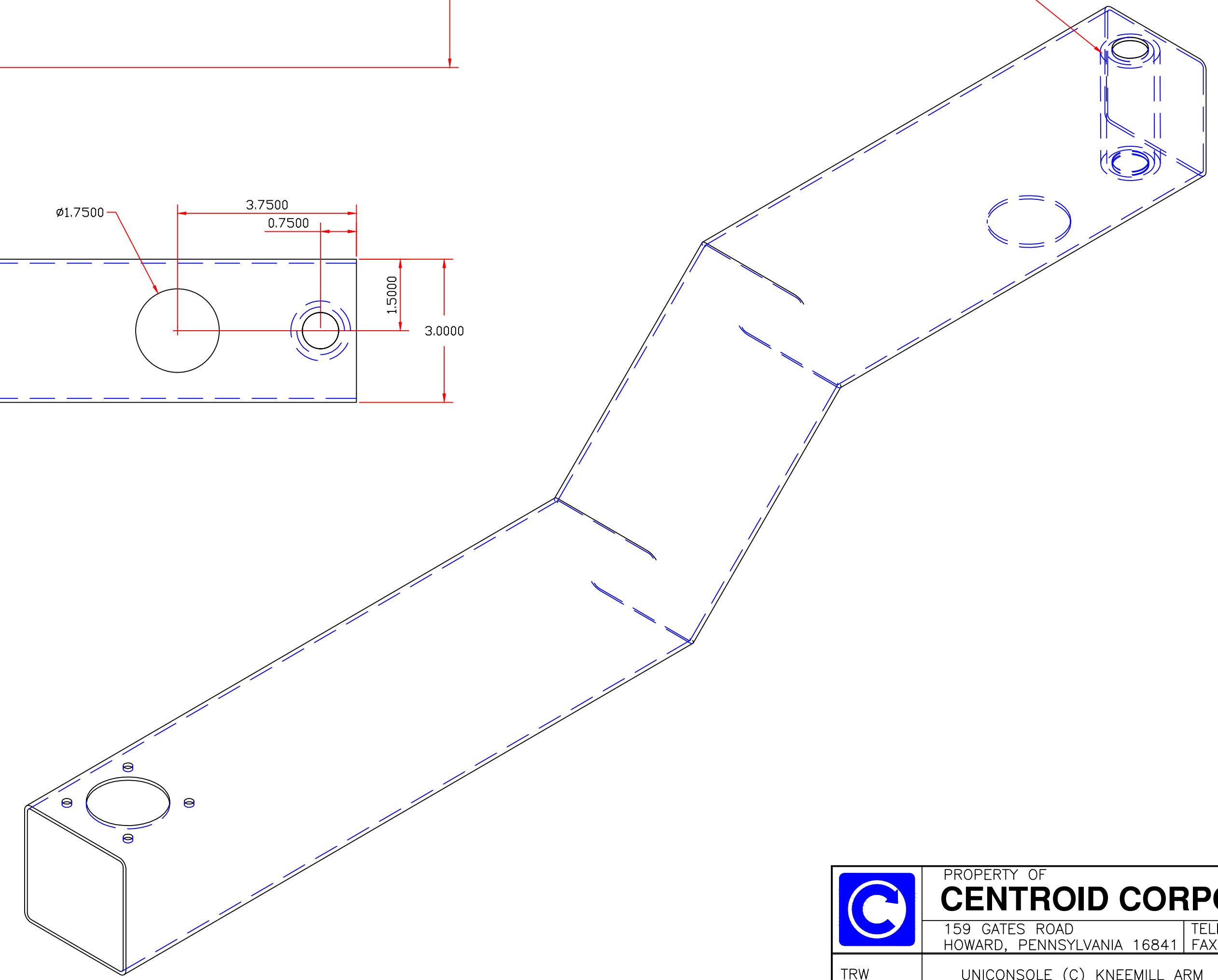

	PROPERTY OF		
	<b>CENTROID CORPORATION</b>		
159 GATES ROAD HOWARD, PENNSYLVANIA 16841		TELE: (814) 353-9290 FAX: (814) 353-9265	
TRW DRAWN:	UNICONSOLE (C) KNEEMILL ARM	TITLE:	SHEET 1 OF 1
01/24/06	N/A	11 GAUGE, 3" TUBE	BLACK POLANE
CHECKED:	SCALE:	MATERIAL: STEEL	FINISH:
TRW APPROVED:	TOLERANCES UNLESS OTHER WISE STATED:	X +0.005 XX +0.010 XXX +0.005	ANGLES: 0.030 0.030
		07-03002	C
		DRAWING #	REV:

COPYRIGHT CENTROID 1998



DRAWING #: 07-3182  
 REV: A

REVISION HISTORY				
ZONE	REV	DESCRIPTION	DATE	APPROVED
NA	A	REPLACES DRAWING# 07-03001 REV. B, PART# 3182	10/17/2006	Tim

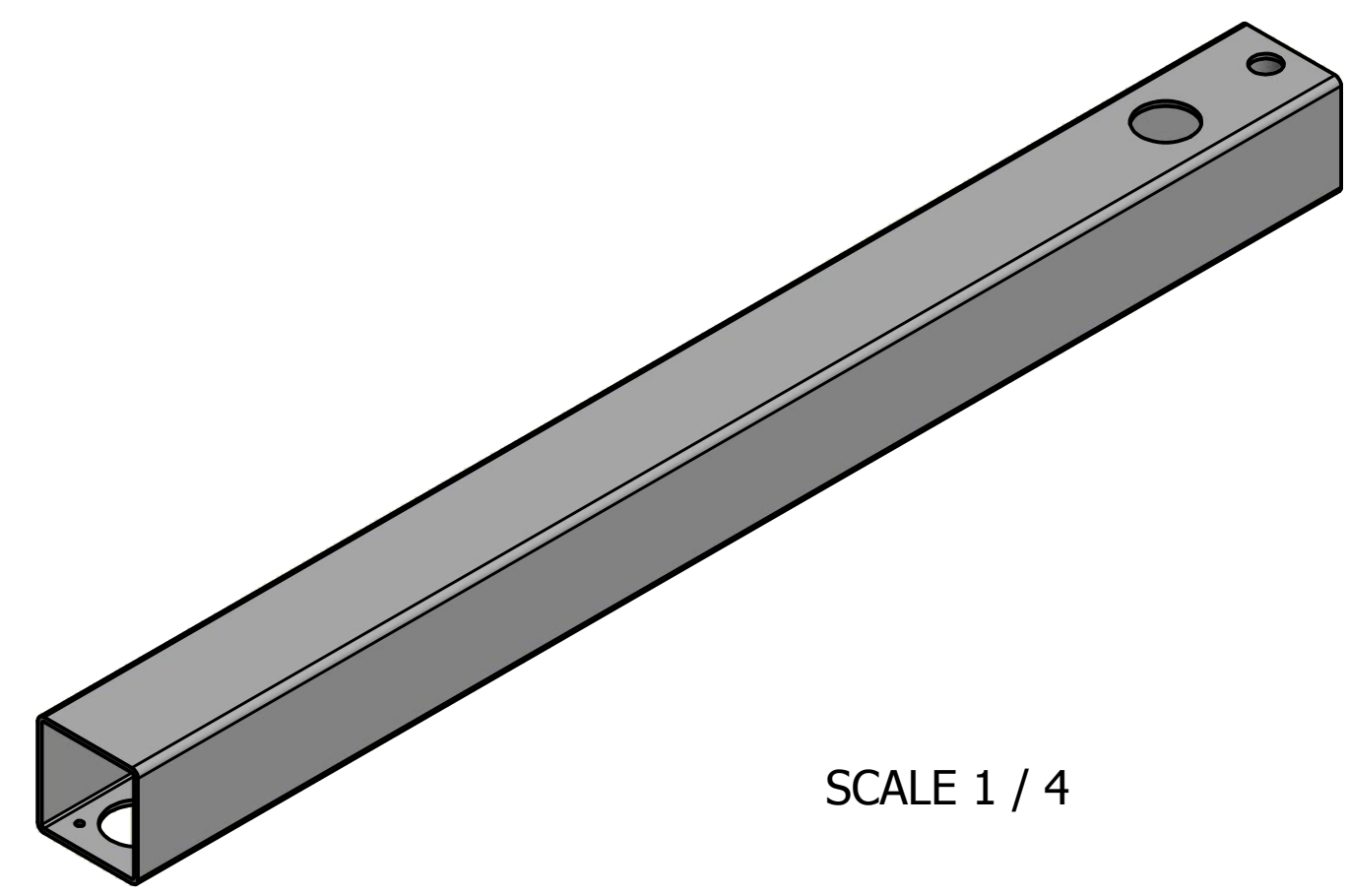

SCALE 1 / 4

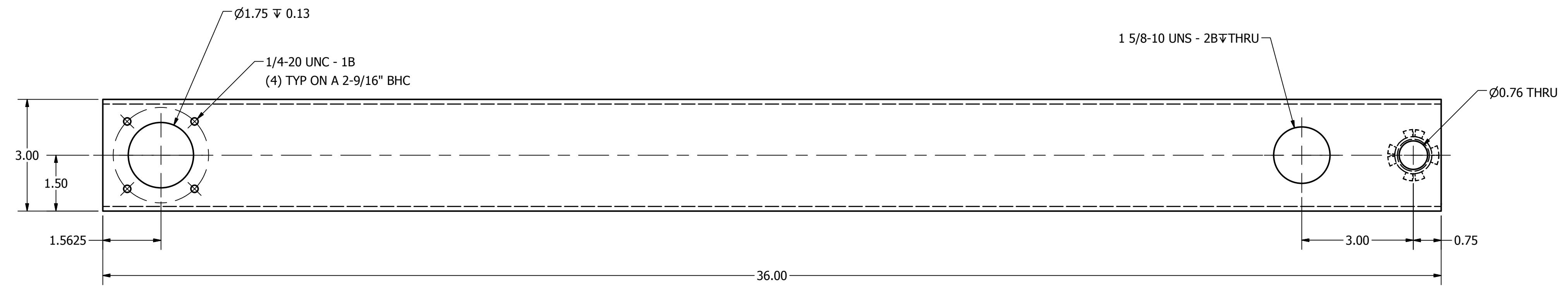
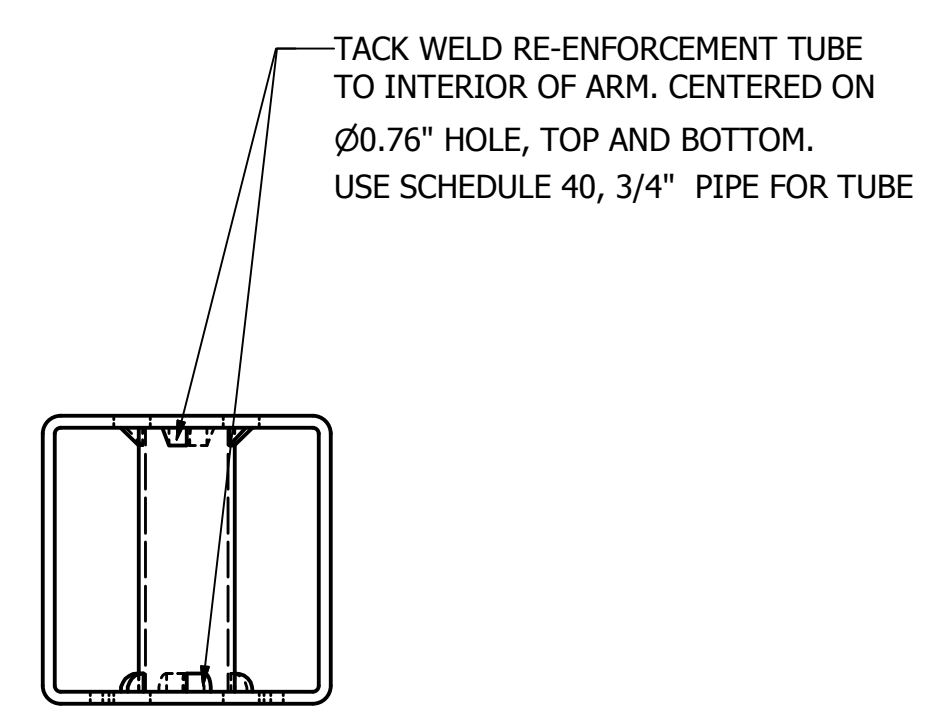

**CENTROID CORPORATION**  
 TEL: (814)353-9290 FAX: (814)353-9265  
 WWW.CENTROIDCNC.COM

DRAWN: TRW	TITLE: CONSOLE ARM, 36"	SHEET #: 1 OF 1
APPROVED:	ASSEMBLY: M400	FINISH: BLACK POLANE
TOLERANCES: X ± 0.025 0' ± 30'	MATERIAL: 11 GAUGE STEEL TUBE	PRODUCT: M400
XX ± 0.010 0.0' ± 3'	SCALE: 1/2	DRAWING #: 07-3182
XXX ± 0.005		REV: A
XXXX ± 0.0005		